

Lowpass Filter with Defected Ground Structure

Parameters:

Substrate: Thickness = 31mil, $\epsilon_r = 2.2$

Frequency: 1-7GHz

Sampling rate: 30 for regular regions, 50 for discontinuities

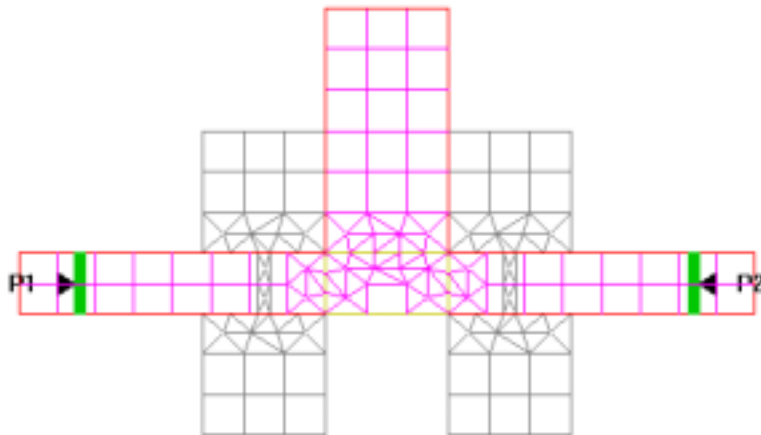
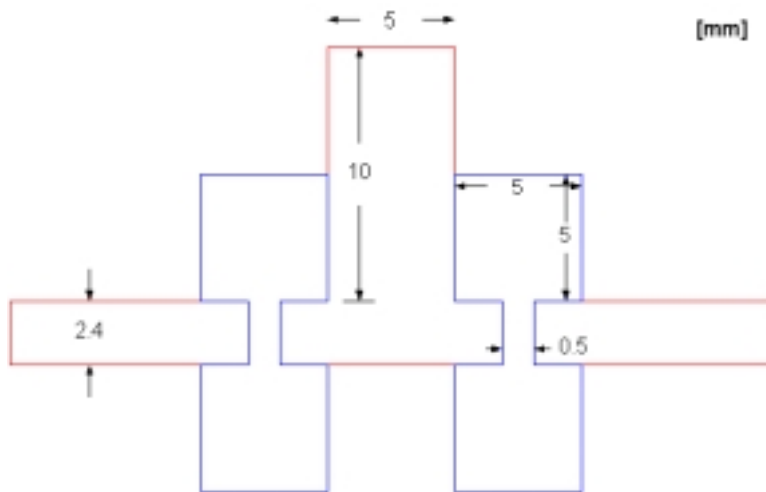

Literature:

Ahn et al, "Design of Lowpass Filter Using Novel Microstrip Defected Ground Structure", IEEE Transactions on Microwave Theory and Techniques, Vol.49, No.1, Jan 01, p.86-93

Results:

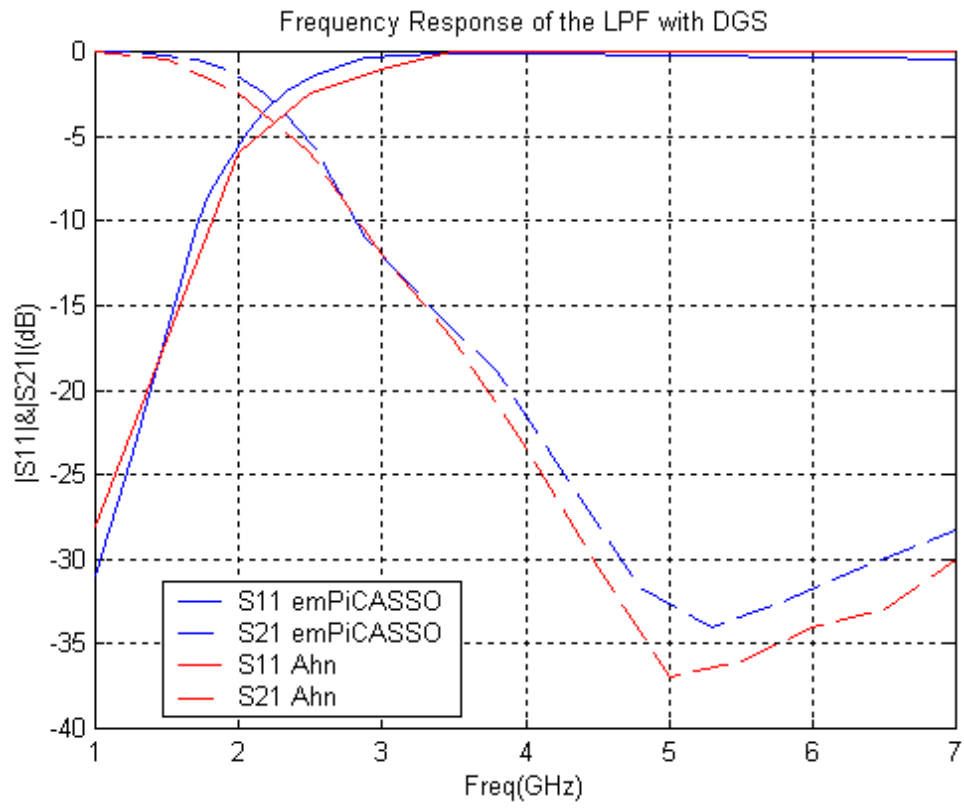

Note: Ahn's results are simulation results from Ansoft HFSS 6.0